

EDUCATIONAL MODELS, DUMMY & DOLLS

ADVANCED NURSING MANIKIN (MALE)

Code : KMMEI-701

Description

- Hair and face wipe
- Eye and ear washing and administering
- Mouth cavity and artificial teeth care
- Endotracheal intubation
- Sputum suction
- Oxygen inhaling
- Oral and nasal feeding
- Gastrolavage
- Main organs in thoracic cavity
- Venipuncture, injection, blood transfusion (Arm)
- Deltoid subcutaneous injection
- Vastus lateralis injection
- Thoracic cavity, abdominal cavity, liver, bone marrow and lumbar puncture
- Enema
- Female urethral catheterization
- Male urethral catheterization
- Female bladder irrigation
- Male bladder irrigation
- Ostomy
- Buttocks intramuscular injection
- Main organs in abdominal cavity
- Holistic nursing care: sponge bath, replacing clothes, cold and heat therapy.
- Limbs joints: bend, rotation and upper or lower movement
- Trauma evaluation and care: washing, disinfection. enswathing of the wound, hemostasis and bandaging.



ADVANCED NURSING MANIKIN (FEMALE)

Code : KMMEI-702

Description

- Hair and face washing, hair combing (with artificial hair)
- Eye and ear washing and administering
- Mouth cavity and artificial teeth care
- Endotracheal Intubation
- Sputum suction
- Oxygen inhaling
- Oral and nasal feeding
- Gastrolavage
- Breast care and inspection
- Venipuncture, injection, blood transfusion (Arm)
- Deltoid subcutaneous injection
- Vastus lateralis injection
- Thoracic cavity, abdominal cavity, liver, bone marrow and lumbar puncture
- Enema
- Female / male urethral catheterization
- Female / male bladder irrigation
- Ostomy
- Buttocks intramuscular injection
- Main organs in abdominal cavity
- Holistic nursing care: sponge bath, replacing clothes, cold and heat therapy.
- Limbs joints: bend, rotation and upper or lower movement





EDUCATIONAL MODELS, DUMMY & DOLLS

MULTI-FUNCTIONAL NURSING MANIKIN (FEMALE)

Code : KMMEI-705

Description

- Hair and face wipe, hair combing and sponge bath
- Mouth cavity care
- Endotracheal intubation
- Oxygen inhaling
- Nasal feeding
- Gastrolavage
- Intracardiac injection
- Closed chest cardiac resuscitation
- Pneumothorax
- Breast care
- Liver puncture
- Chest drainage
- Abdominal drainage
- Bone marrow puncture
- Deltoid subcutaneous injection
- Venipuncture injection
- Blood transfusion (Arm)
- Vastus lateralis injection
- Female urethral catheterization
- Female bladder irrigation
- Buttocks intramuscular injection



ARTIFICIAL HUMAN SKELETON (MALE)

Code : KMMEI-707

Description

- The model shows all the anatomic details of the skeleton structure.
- Joint and upper, lower extremities is removable.
- Size : 173 (Male), 162 cm (Female)
- Material : Advanced PVC

HUMAN SKELETON (MALE) 85 CM

Code : KMMEI-709

Description

- The model shows all the anatomic details of the skeleton structure.
- Joint and upper, lower extremities is removable.
- Size : 85 cm
- Material : Advanced PVC



EDUCATIONAL MODELS, DUMMY & DOLLS

FETUS WITH PLACENTA

Code : KMMEI-711

Description

- Newborn Fetus, Umbilical Cord, with Placenta



A Matrix For Delivery Demonstration



B Fetus For Demonstration



B Fetus For Demonstration

CHILDBIRTH SIMULATOR

Code : KMMEI-712

Description

- Demonstrate the whole process of delivery.
 - Demonstrate the fetus, umbilical cord and placenta of vacuum-assisted delivery, flexible fetal joint, and multiple normal and abnormal positions of fetal delivery can be showed.
 - Can practise and master the comprehensive skills of normal labor, abnormal labor (dystocia), midwifery and perineum protection.
 - Available training of multiple pregnancy (twin pregnancy)
- Component: A (Matrix For Delivery Demonstration) B (Fetus For Demonstration) X 2

ADVANCED CHILDBIRTH SIMULATOR

Code : KMMEI-716

Description

- Demonstrate the fetus, umbilical cord and placenta of vacuum-assisted delivery, flexible fetal joint, and multiple normal and abnormal positions of fetal delivery can be showed.
 - Equipped with manual delivery mechanical parts; with the help of hands, the whole delivery process, including engagement descending, flexion, internal rotation, extension, restoration, external rotation and fetal delivery can be showed;
 - 3.Can practise and master the comprehensive skills of normal labor, C Matrix For Manual Delivery Demonstration
 - Abnormal labor (dystocia), midwifery and perineum protection
- Component: B (Fetus For Demonstration) + C (Matrix For Manual Delivery Demonstration)



C Matrix For Manual Delivery Demonstration

B Fetus For Demonstration

EDUCATIONAL MODELS, DUMMY & DOLLS

ADVANCED SUBCUTANEOUS EMBEDDED CONTRACEPTIVE TRAINING ARM

Code : KMMEI-719

Description

- Impact material, realistic model, simulating left upper arm and lamps layer, mounted on the base plate.
- Exercise of subcutaneous embed and dislodging contraceptive material.
- Skin can be fixed
- Standby skin bnd 12 pcs insertion tube , can be replaced.



VASOLIGATION TRAINING SIMULATOR

Code : KMMEI-721

Description

- Accurate anatomic structure. Can touch the vas deferens on the upper end of the testis.
- Training practice can be done in the classic way: to cut off or ligate the vas deferens to block the output of sperm and ensure sterilization.
- Training practice can also be done as per new technology : No Scalpel Vasectomy (NSV), to block the output of sperm and ensure sterilization.
- Provide easily replaceable genital parts (including two pieces of testis and mobile scrotal skin and two pieces of vas deferens. Can be used repeatedly in training practice.



ADVANCE INSPECTION AND PALPATION OF BREAST SIMULATOR

Code : KMMEI-724

Description

- Contains various common typical signs of breast tumor, specially designed for clinical diagnosis.
- Good quality import material.
- Different area provide different simulative characteristics can sufficiently meet the teaching requirement.
- The model provides the following pathological:
 - Nodule: malignant tumor: hard, fixed, irregular surface
 - Benign tumor: relatively soft, smooth, surface
 - Lymph metastases: armpit and neck can touch the hard lymph nodules sagging
 - The change of nipper: sagging nipple has burst and blood liquid flow out
 - The charge of skin: sagging skin, orange peel appearance



ADVANCE FUNDUS OF UTERUS EXAMINATION AND EVALUATION SIMULATOR

Code : KMMEI-726

Description

- With normal physiological changes of the postpartum women, provide assessment of postpartum fundus of uterus and massage skills training;
- Hip joint is movable and can be placed correct body position.
- Realistic anatomical landmark of united bones of toes,
- Interchangeable Uterus:
 - Normal uterus
 - Postpartum uterus of the first hour
 - Postpartum uterus of the second day
 - Postpartum uterus of the second week
 - Callous uterus with good contraction
 - Soft uterus without good contraction
- Expansion of vaginal orifice
- Easy to separate the labium minus and expose the vagina,
- Lear energy of cunnus



ADVANCE PEDIATRIC VENIPUNCTURE HAND MODEL

Code : KMMEI-728

Description

- The model consists of simulated pediatric arm model, with realistic blood flow and real operation;
- Life size of pediatric left arm, made of imported thermoplastic material, soft skin, and with obvious osteal identification marker;
- Bendable back of hand, provide training of opisthenar venipuncture, haemospasia and transfusion. There is obvious feeling when needle penetrates into veins. And blood flash back indicates proper insertion.
- With basement support, beautiful and convenient.



CHILD IV TRAINING ARM

Code : KMMEI-729

Description

- Life size of infant left arm, made of imported thermoplastic material, soft skin and have obvious osteal identification marker;
- Bendable back of hand, provide training of opisthenar venipuncture, haemospasia and transfusion.
- There is obvious feeling when needle penetrates into the vein. And blood flash back indicates proper insertion.



ADVANCE YOUNG CHILDREN VENIPUNCTURE ARM MODEL

Code : KMMEI-730

Description

- Simulate the arm of child (4 years old).
- Lifelike arm reproduction with multi-vein system designed for peripheral intravenous therapy.



EDUCATIONAL MODELS, DUMMY & DOLLS

GYNOCOLOGICAL EXAMINATION SIMULATOR

Code : KMMEI-733

Description

This is an adult female torso with simulated abdomen and pelvis, can demonstrate the following:

- Palpation examination of normal and various abnormal uterus
- Bi-manual pelvic and tri-manual pelvic examination
- Examine the normal cervix via vaginoscope and colposcope
- Macroscopic observation normal and various abnormal lesions cervical
- Place and remove the IUD
- Observe the size and location of diaphragm
- Observe the uterus ovaries fallopian, round ligament and other anatomy structure of pelvic
- Size: 68.5cm x 29cm x 55.5cm



IUD TRAINING MODEL

Code : KMMEI-738

Description

- Basing on real anatomy of female genitalia, we designed this model for instructing or training of insertion or removal IUD.
- The uterus is in coronal section and covered with transparent plastic window. So students can directly observe whole insertion or removal process.



NEWBORN BABY MODEL LIGHT

Code : KMMEI-744

Description

- Newborn baby without umbilical cord
- Size : 52.5cm x 27cm x 15.5cm
- G.W.: 1.5kg



GD/FT3

NEWBORN BABY MODEL

Code : KMMEI-746

Description

- KMC Doll, Available with BHOTE Clothes, & Umbilical Cord,



INFANT OBSTRUCTION MODEL

Code : KMMEI-735

Description

The product is designed for practicing Heimlich maneuver. The manikin is designed according to infant anatomic and physiological characteristics and suitable for airway foreign body emergency. Airway foreign body is common in infant and children. Infant and children due to immature epiglottal cartilage and unsmooth function, it is easy to inhale the contents into trachea, if they speak, cry, laugh and do active activities with contents in the mouth, it would cause airway obstruction and choking.

- Back blow method: let patient ride and pronate on the rescuer's arm with head lower than trunk, fix head and put his arm on rescuer's thigh, then blow patient back forcefully 4-6 times with the other hand, so that a sudden increase in airway pressure can help loosen and discharge the foreign body.
- Chest-thrust method: Let patient in supine position and hold in rescuer's arm, with head a little lower than trunk; press the middle part between two nipples 4-6 times with two fingers. When necessary, the two methods can be interchangeably used until the foreign body is discharged
- or patient loss consciousness.

Features:

- Artificial respiration and external chest compression;
- Simulation of natural airway;
- Airway opening and chest compression;
- Chest rise when airway opened;
- Simulation of foreign-body airway obstruction.



IUD TRAINING MODEL

Code : KMMEI-739

Description

The model accurately shows uterine lateral section, with transparent membrane covering on the model, can clearly observe IUD insertion and placement process



NEWBORN BABY MODEL WITH UMBILICAL CORD

Code : KMMEI-745

Description

- Newborn baby with visible umbilical cord
- Size : 52.5cm x 27cm x 15.5cm
- G.W.: 2.5kg



GD/FT2

MALE CONDOM MODEL

Code : KMMEI-749

Description

- Lifelike model is used to demonstrate the use of condoms.
- An erect penis, 12 pcs condoms, syringe and simulative serene.
- Simulate ejaculation operation process.



Size : 29cm x 20cm x 13cm
G.W.: 0.7kg

EDUCATIONAL MODELS, DUMMY & DOLLS

MAMA BIRTHIE LITE

Code : KMMEI-752

Description

- Hair and face wipe, hair combing and sponge bath
- Mouth cavity care
- Endotracheal intubation
- Oxygen inhaling
- Nasal feeding
- Gastrolavage
- Intracardiac injection
- Closed chest cardiac resuscitation
- Pneumothorax
- Breast care
- Liver puncture
- Chest drainage
- Abdominal drainage
- Bone marrow puncture
- Deltoid subcutaneous injection
- Venipuncture injection
- Blood transfusion (Arm)
- Vastus lateralis injection
- Female urethral catheterization
- Female bladder irrigation
- Buttocks intramuscular injection



MAMA NATALIE LIGHT

Code : KMMEI-755

Description

MamaNatalie helps build confidence and competency of health workers and teams in the prevention and management of postpartum hemorrhage. This wearable birthing simulator is designed specifically for the third stage of labor by simulating realistic bleeding.



NEONATALIE LIGHT

Code : KMMEI-757

Description

NeoNatalie is an inflatable simulator designed to teach basic neonatal resuscitation skills. Developed to meet the key requirements for teaching the initial steps of resuscitation in the first ten minutes of a newborn's life, NeoNatalie is an effective, cost-efficient tool to enhance your training program.



MAMA-U

Code : KMMEI-759

Description

Mama-U represents a postpartum uterus after birth. It supports training in postpartum IUD and uterine balloon tamponade insertions and other postpartum uterus interventions. The model is ultra-portable and can be used as a tabletop model for task training, or inside Mama Natalie for a complete birth simulation.

EDUCATIONAL MODELS, DUMMY & DOLLS

SISTER U

Code : KMMEI-760

Description

- The uterus plate of Sister-U can be flipped to demonstrate different uterine angles.
- Sister-U can be used with a variety of reproductive health methods such as cervical rings and diaphragms.
- The uterus modules can be removed from the frame and be used as demonstration tools.
- Sister-U's carrying case can be worn on the shoulder or converted into a backpack.



MAMABREAST

Code : KMMEI-761

Description

MamaBreast is a breastfeeding simulator which supports training in exclusive breastfeeding, manual expression and Kangaroo Mother Care. The simulator also facilitates learning of communication skills.

PENGUIN SUCTION

Code : KMMEI-765

Description

Penguin Newborn Suction is a reusable suction bulb intended for removal of fluids from a newborn's nasal and oral cavities. It is made of transparent, silicone for effective cleaning and high durability. Soft, flexible suction tip with length and shape designed to reduce potential harm to newborn.

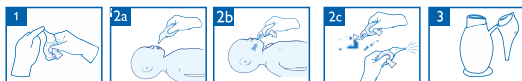

NIFTY CUP

Code : KMMEI-766

Description

Nifty feeding cup is a reusable product designed as a solution for babies with breastfeeding difficulties that allows the baby to control the pace of feeding. It is easy to use and clean, and avoids the wasting of breast milk.





EDUCATIONAL MODELS, DUMMY & DOLLS



UPRIGHT PEEP NEWBORN MASK KIT

Code : KMMEI-768

Description

The Laerdal Upright Resuscitator offers a new approach to ventilations. The ergonomic upright design of the bag and mask makes it easier for Healthcare Providers to seal the patient's nose and mouth securely whilst delivering ventilations.

MAYO FETAL HEART RATE MONITOR

Code : KMMEI-770

Description

- Moyo is a compact digital fetal monitor used during labor to help healthcare providers make timely, informed decisions by providing quick and accurate feedback on fetal heart rate.
- Timely and accurate monitoring
- A 9-crystal sensor accurately detects the fetal heart rate within seconds without needing to know the baby's position. Dual electrodes differentiate the maternal from the fetal heart rate which differs from a regular doppler. Moyo can be used continuously or intermittently.



NEOBEAT NEWBORN HEART RATE METER

Code : KMMEI-771

Description

- NeoBeat is an easy-to-use heart rate meter that guides healthcare workers during newborn resuscitation. It quickly provides objective feedback on the newborn's condition through accurate and continuous heart rate information.
- NeoBeat supports decision-making during care and provides feedback that improves the confidence and efficacy of provider intervention.
- Newborn heart rate, instantly
- Get timely heart rate information that can guide and improve care. NeoBeat is faster and more accurate than other available methods like stethoscopes, pulse oximetry or umbilical cord palpation.
- Decision-making based on objective feedback
- NeoBeat uses dry electrodes to pick up an ECG-based signal. This is the most reliable way to measure newborn heart rate, recommended by The International Liaison Committee on Resuscitation (ILCOR) 2015 guidelines.



NeoBeat 532-00000



NeoBeat Mini 531-00000

